



Your Lake George Real Estate Experts!

Davies Davies & Associates

P.O. Box 201, Cleverdale, NY 12820

P: (518) 656-9068 F: (518) 656-9087

www.davies-davies.com

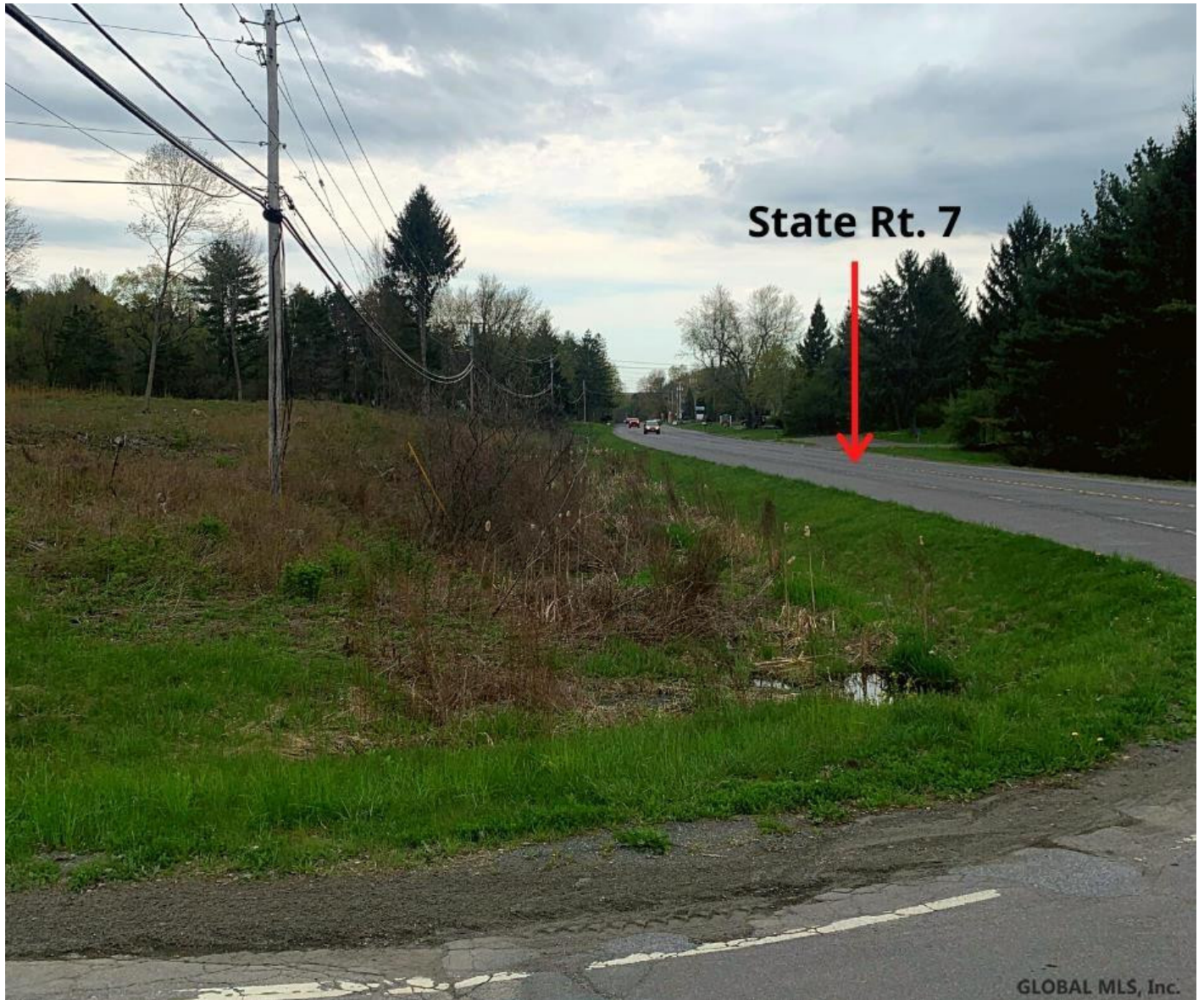

GLOBAL MLS, Inc.

Listing courtesy of: Howard Hanna

MLS# - 202222715 - Price: \$259,900

L50.111 State Highway 7 , Troy, NY

Description: Location. Location. Location. 3.05 Acres w/ 399 FT. FRONTAGE on State Rt. 7. Minutes from Downtown Troy & bustling traffic to Vermont. Property Zoned in 2020. Light-Commercial. This is a PRIME LOCATION. No Other Current Commercial Properties w/ 2 Entrances, DOT Approved. Property is Cleared, Stumped, w/ Power at road, French Drain added & Property is Dry. Take advantage & be the 1st to convert this long traffic corridor into the business(s) of your choice or tenant fit up. Preliminary soil testing prior to land purchase. Town approval required. Contact LA



Your Lake George Real Estate Experts!

Davies Davies & Associates

P.O. Box 201, Cleverdale, NY 12820

P: (518) 656-9068 F: (518) 656-9087

www.davies-davies.com

for Add. Info & Showing. Lease Option Available.

Acres: 3.05

School District: Brunswick
(brittonkill)

Sewer: None

Town: Brunswick

Estimated Taxes: \$495

County: Rensselaer

Property Type: Land

Water: Public

Zoning: Commercial



Daniel Davies
NYS Licensed Real Estate
Broker GRI, ABR,
RSPS, SRS, C2EX
(518) 656-9068
dan@daviesrealty.net

